

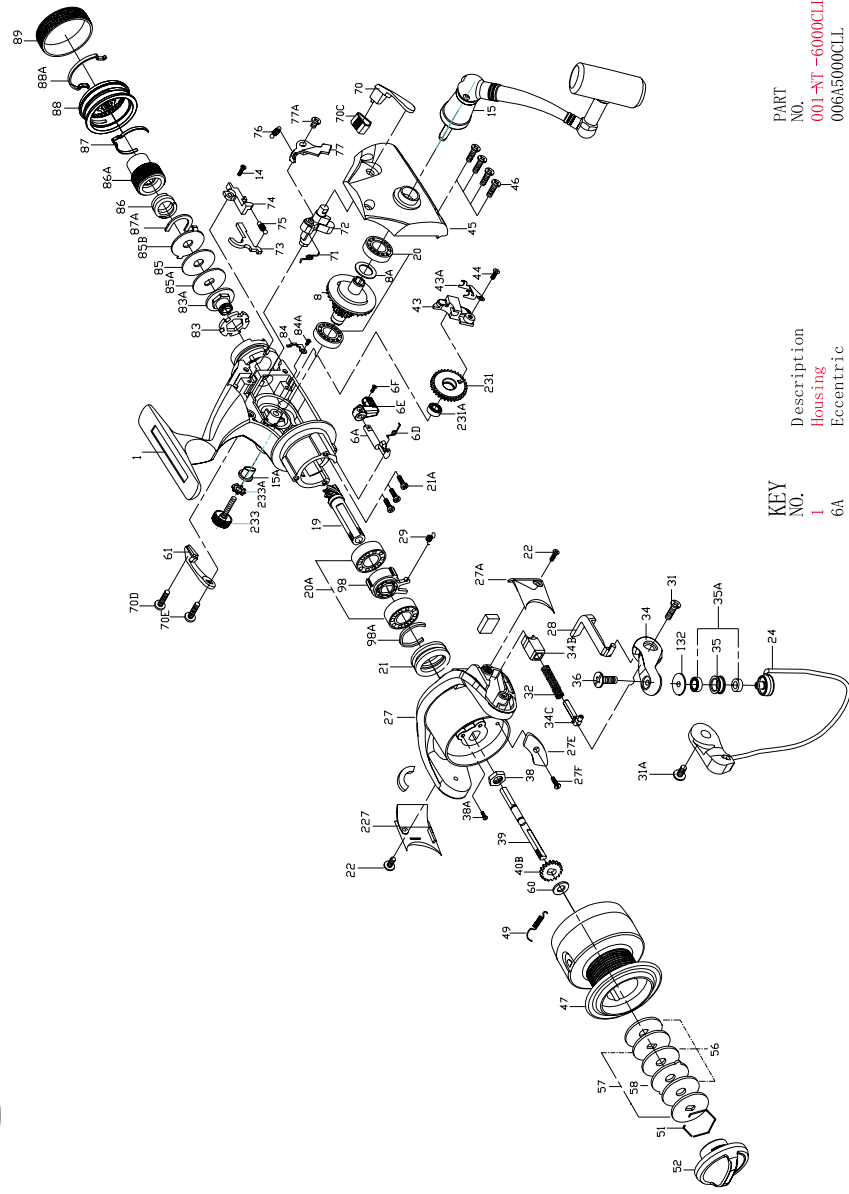

PARTS LIST FOR MODEL CLL6000



KEY NO.	Description	PART NO.
28	Trip Lever	028 6000CV
29	Spring	029 5000CV
31	Bail Arm Screw	031 2000CV
31A	Bail Wire Screw	031A2000CV
32	Bail Spring	032 4000CV
34	Bail Arm	034 5000CV
34B	Pivot Guide	034B5000CV
34C	Pivot Arm	034C4000C V
35	Line Roller	035 2000CV
35A	Line Roller Ball Bearing (2 req)	035A2000CV
36	Bail Stud Screw	036 2000CV
38	Rotor Nut	038 5000CV
38A	Rotor Nut Screw	038A2000CV
39	Spool Shaft	039 5000CCL
40B	Click Ratchet	040B5000CV
43	Crosswind Block	043 5000CCL
43A	Spool Shaft Clip	043A5000CCL
44	Crosswind BlockScrew	044 2000CV
45	Housing Cover	045-HT-6000CCL
46	Housing Cover Screws (4 req)	046 5000CV
47	Spool Assembly	047 6000CCL
49	Click Spring	049 2000CV
51	Retaining Ring	051 2000CV
52	Drag Knob	052 5000CV
56	Friction Drag Washer (3 req)	056 2000CV
57	Keyed Washer (2 req)	057 5000CV
58	Drag Washer Barred	058 2000CV
60	Thrust Washer	060 5000CCL
70	L.S. Liveline Eccentric Lever	070 5000CCL
70B	R.S. Liveline Eccentric Lever	070B 5000CCL
70C	(Mid) Liveline Eccentric Lever	070C 5000CCL
70D	Liveline Eccentric Lever Screw	070D 4000CCL
70E	Liveline Eccentric Lever Screw	070E4000CCL
71	Liveline Liveline Eccentric Spring	071 4000CCL
72	Liveline Eccentric	072 5000CCL
73	LivelinePlate	073 5000CCL
74	Liveline Dog	074 5000CCL
75	Dog Spring	075 5000CCL
76	Trip Spring	076 4000CCL
77	Eccentric Trip	077 4000CCL
77A	Eccentric Trip Screw	077A4000CCL
83	Rear Drag Ratchet	083 5000CCL
83A	Rear Ratchet Insert	083A5000CCL
84	Rear Drag Click	084 5000CCL
84A	Click Spring Screw	084A 4000CCL
85	Rear Drag Washer	085 5000CCL
85A	Rear Keyed Washer	085A5000CCL
85B	Rear Earred Washer	085B5000CCL
86	Rear Drag Spring	086 5000CCL
86A	Rear Drag Nut	086A5000CCL
87	Rear Click Spring	087 5000CCL
87A	Rear Drag Retainer	087A5000CCL
88	Rear Drag Knob	088 5000CCL
88A	Rear Drag Knob Retainer	088A5000CCL
89	Rear Drag Knob Grip	089 5000CCL
98	Clutch Retainer	098 5000CCL
98A	Clutch Clip	098A5000CCL
132	Roller Washer	132 2000CV
227	Cam Cover	227 5000CV
231	Crosswind gear	231 5000CCL
231A	Crosswind gear Ball Bearing	020 500CV
233	Bearing Cover	233N 2000CV
233A	Handle Cap Washer	233A 2000CV

KEY NO.	Description	PART NO.
1	Housing	001-HT-6000CCL
6A	Eccentric	006A5000CCL
6D	Eccentric Spring	006D 4000CCL
6E	Eccentric Lever	006E5000CCL
6F	Eccentric Lever Mounting Screw	006F-5000CCL
8	Main Gear Assembly	008 5000CCL
8A	Main Gear Shim	008A5000CV
14	Screw	014 5000CCL
15	Handle Assembly	015N6 000CV
15A	Handle Retaining Bushing	015A500CV
19	Pinion Gear	019 5000CCL
20	Housing Ball Bearing (2 req.)	020 5000CV
20A	Pinion Ball Bearing (2 req.)	020A500 0CV
21	Collar	021 5000CV
21A	Bearing Mounting Screws (3 req.)	021A2000CV
22	Cover Screw (2 req.)	022 500CV
24	Bail Wire	024 6000CV
27	Rotor Cup	027 000CV
27A	Bail Pivot Cover	027A5000CV
27E	Balance Weight	027E5000CV
27F	Balance Weight Screw	027F2000CV