

Congratulations on the purchase of your new Penn International® baitcaster! For general features, operating instructions, casting control information, maintenance, lubrication and servicing, please refer to the main International® manual (featuring the 965). Keep this sheet for reference to 975 part numbers and specifications. Good fishing!

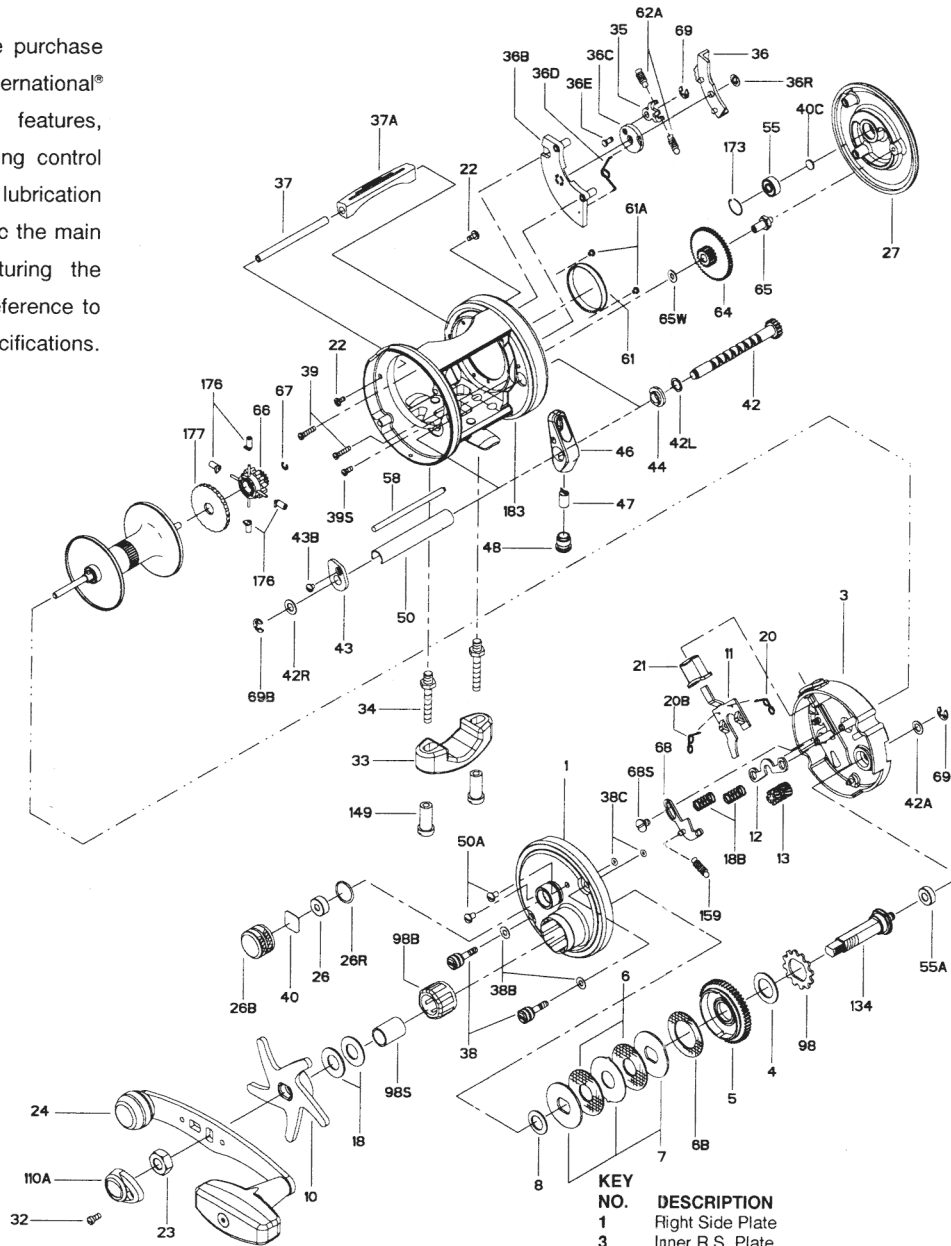

| KEY NO. | DESCRIPTION | PART NO. | DESCRIPTION | PART NO. |
|---------|-------------------------------|----------|-------------|----------|
| 12 | Yoke | 12-965 | | |
| 13 | Pinion | 13-975 | | |
| 18 | Disc Clutch Spring (2 req.) | 18-975 | | |
| 18B | Yoke Spring (2 req.) | 18B-975 | | |
| 20 | R.S. Jack Spring | 20-965 | | |
| 20B | L.S. Jack Spring | 20B-965 | | |
| 21 | Clutch Release Button | 21-975 | | |
| 22 | Post Screw (2 req.) | 50-716 | | |
| 23 | Handle Nut | 23-555 | | |
| 24 | Handle Assembly | 24-975 | | |
| 26B | Spool Tension Cap | 26B-965 | | |
| 26R | Tension Cap 'O' Ring | 26R-965 | | |
| 27 | Left Side Plate | 27-975 | | |
| 29L | Spool Assembly | 29L-975 | | |
| 32 | Handle Cap Screw | 32-15 | | |
| 33 | Rod Clamp | 33-113 | | |
| 34 | Rod Clamp Screw (2 req.) | 34-975 | | |
| 35 | Click Tongue | 35-965 | | |
| 36 | Click Button | 36-975 | | |
| 36B | Click Housing | 36B-975 | | |
| 36C | Click Wheel | 36C-965 | | |
| 36D | Click Wheel Spring | 36D-965 | | |
| 36R | Retaining Ring (2 req.) | 36R-965 | | |
| 37 | Thumb Bar Post | 37-975 | | |
| 37A | Thumb Bar | 37A-975 | | |
| 38 | Take-Apart Screw (2 req.) | 38-965 | | |
| 38B | Side Plate Washer (2 req.) | 38B-965 | | |
| 38C | Screw 'O' Ring (2 req.) | 38C-965 | | |
| 39 | L.S. Plate Screw (2 req.) | 39-965 | | |
| 39S | L.S. Plate Short Screw | 39S-965 | | |
| 40 | Metal Thrust Washer | 40C-965 | | |
| 40C | Metal Thrust Washer | 40C-310 | | |
| 42 | Worm Shaft | 42-975 | | |
| 42A | Metal Washer | 42R-965 | | |
| 42L | L.S. Worm Shaft Washer | 42L-965 | | |
| 42R | R.S. Worm Shaft Washer | 42R-965 | | |
| 43 | R.S. Worm Shaft Bushing | 43-965 | | |
| 43B | Worm Bushing Screw | 43B-965 | | |
| 44 | L.S. Worm Shaft Bushing | 44-975 | | |
| 46 | Line Guide | 46N-965 | | |
| 47 | Pawl | 47-320 | | |
| 48 | Pawl Cover Screw | 48-965 | | |
| 50 | Worm Shield | 50-965 | | |
| 50A | R.S. Plate Screw (2 req.) | 50-716 | | |
| 55 | Ball Bearing (2 req.) | 55-113H | | |
| 55A | Gear Stud Bushing | 55A-965 | | |
| 58 | Line Guide Post | 58-975 | | |
| 61 | Brake Drum | 61-965 | | |
| 61A | Brake Drum Screw (2 req.) | 43B-965 | | |
| 62A | Click Spring (2 req.) | 62A-965 | | |
| 64 | Idler Gear | 64-975 | | |
| 65 | Idler Gear Pin | 65-965 | | |
| 65W | Idler Gear Washer | 65W-965 | | |
| 66 | Spool Gear Click Ratchet | 66M-965 | | |
| 67 | Lock Ring | 67-16S | | |
| 68 | Shift Arm | 68-965 | | |
| 68S | Shift Arm Screw | 68S-965 | | |
| 69B | Retaining Ring (2 req.) | 69B-600 | | |
| 98 | Trip Ratchet | 98-965 | | |
| 98B | Roller Bearing | 98B-525 | | |
| 98S | Bearing Clutch Shaft | 98S-525 | | |
| 110A | Handle Nut Cap | 110A-555 | | |
| 134 | Gear Stud | 134-975 | | |
| 149 | Rod Clamp Nut (2 req.) | 149-45 | | |
| 159 | Shift Arm Spring | 159-965 | | |
| 173 | L.S. Bearing Retainer | 173-965 | | |
| 176 | Anti-Backlash Brakes (4 req.) | 176-965 | | |
| 177 | Brake Selection Knob | 177-965 | | |
| 183 | Frame Assembly | 183-975 | | |

| KEY NO. | DESCRIPTION | PART NO. |
|---------|------------------------------|----------|
| 1 | Right Side Plate | 1-975 |
| 3 | Inner R.S. Plate | 3-975 |
| 4 | Fibre Washer | 4-60 |
| 5 | Main Gear | 5-975 |
| 6 | Drag Washer HT-100 (2 req.) | 6-309 |
| 6B | Drag Washer HT-100 | 6B-965 |
| 7 | Metal Drag Washer (Set of 3) | 7C-965 |
| 8 | Star Tension Washer | 8-60 |
| 10 | Star Drag | 10-975 |
| 11 | Eccentric Jack | 11-975 |

| LINE CAPACITY | GEAR RATIO | WEIGHT |
|----------------------|------------|-----------|
| 340 YDS / 15 LBS | 4.5:1 | 15 OZ |
| 310 METERS / 0.40 MM | | 425 GRAMS |