

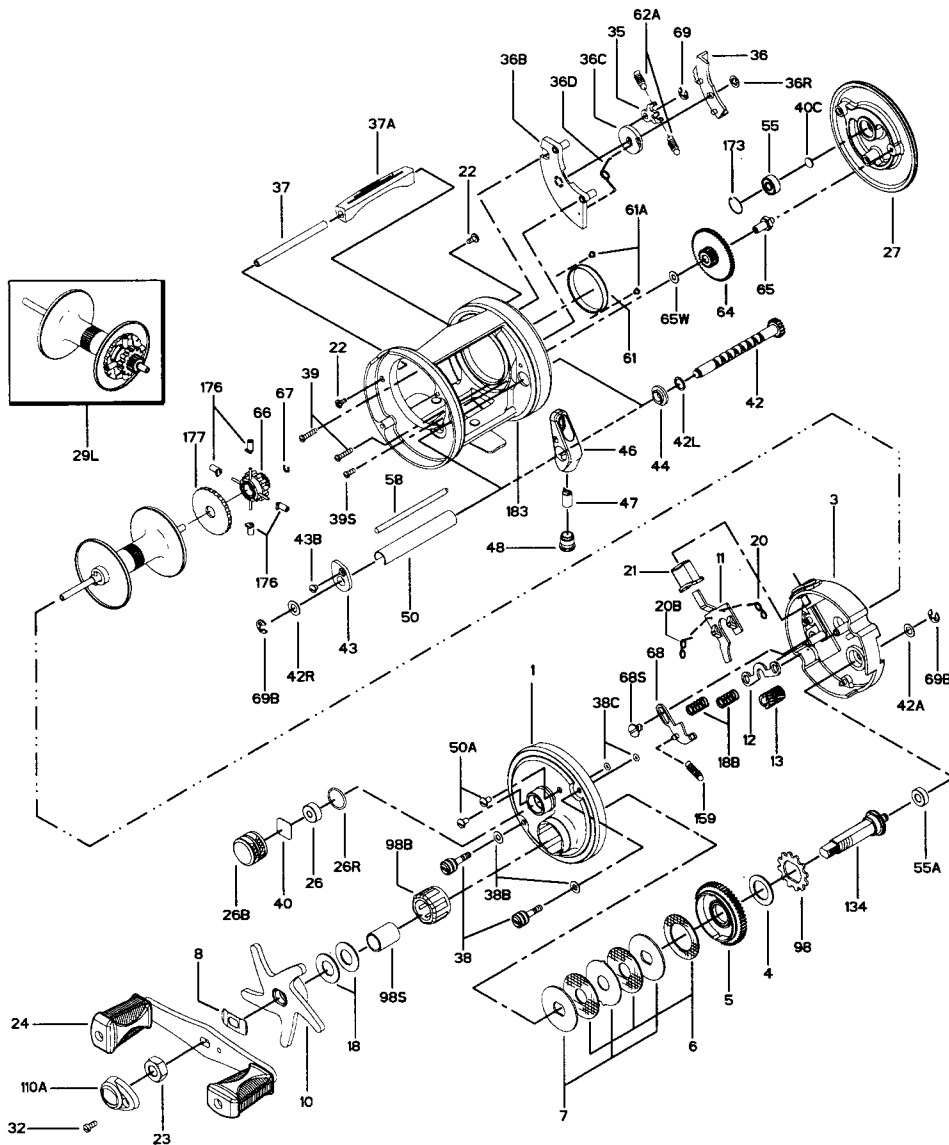

PARTS LIST FOR MODEL 955 AND 965



KEY NO.	DESCRIPTION	MODEL 955 PART NO.	MODEL 965 PART NO.
11	Eccentric Jack	11-965	11-965
12	Yoke	12-965	12-965
13	Pinion	13-965	13-965
18	Disc Clutch Spring (2 req.)	18-965	18-965
18B	Yoke Spring (2 req.)	18B-965	18B-965
20	R.S. Jack Spring	20-965	20-965
20B	L.S. Jack Spring	20B-965	20B-965
21	Clutch Release Button	21-965	21-965
22	Post Screw (2 req.)	50-716	50-716
23	Handle Nut	23-965	23-965
24	Handle Assembly	24-965	24-965
26	R.S. Plate Bushing	26-965	26-965
26B	Spool Tension Cap	26B-965	26B-965
26R	Tension Cap 'O' Ring	26R-965	26R-965
27	Left Side Plate	27-965	27-965
29L	Spool Assembly	29L-955	29L-965
32	Handle Cap Screw	32-15	32-15
35	Click Tongue	35-965	35-965
36	Click Button	36-965	36-965
36B	Click Housing	36B-965	36B-965
36C	Click Wheel	36C-965	36C-965
36D	Click Wheel Spring	36D-965	36D-965
36R	Retaining Ring	36R-965	36R-965
37	Thumb Bar Post	37-955	37-965
37A	Thumb Bar	37A-955	37A-965
38	Take-Apart Screw (2 req.)	38N-965	38N-965
38B	Side Plate Washer (2 req.)	38BN-965	38BN-965
38C	Screw 'O' Ring (2 req.)	38CN-965	38CN-965
39	L.S. Plate Screw (2 req.)	39-965	39-965
39S	L.S. Plate Short Screw	39S-965	39S-965
40	Metal Thrust Washer	40C-965	40C-965
40C	Metal Thrust Washer	40C-310	40C-310
42	Worm Shaft	42M-955	42M-965
42A	Metal Washer	42R-965	42R-965
42L	L.S. Worm Shaft Washer	42L-965	42L-965
42R	R.S. Worm Shaft Washer	42R-965	42R-965
43	R.S. Worm Shaft Bushing	43-965	43-965
43B	Worm Bushing Screw	43B-965	43B-965
44	L.S. Worm Shaft Bushing	44-965	44-965
46	Line Guide	46-965	46-965
47	Pawl	47-320	47-320
48	Pawl Cover Screw	48-965	48-965
50	Worm Shield	50-955	50-965
50A	R.S. Plate Screw (2 req.)	50-716	50-716
55	Ball Bearing	55-113H	55-113H
55A	Gear Stud Bushing	55A-965	55A-965
58	Line Guide Post	58-965	58-965
61	Brake Drum	61-965	61-965
61A	Brake Drum Screw (2 req.)	43B-965	43B-965
62A	Click Spring (2 req.)	62A-965	62A-965
64	Idler Gear	64M-965	64M-965
65	Idler Gear Pin	65-965	65-965
65W	Idler Gear Washer	65W-965	65W-965
66	Spool Gear Click Ratchet	66M-965	66M-965
67	Lock Ring	67-16S	67-16S
68	Shift Arm	68-965	68-965
68S	Shift Arm Screw	68S-965	68S-965
69	Retaining Ring	69B-50	69B-50
69B	Retaining Ring (2 req.)	69B-600	69B-600
98	Trip Ratchet	98-965	98-965
98B	Roller Bearing	98B-965	98B-965
98S	Bearing Clutch Shaft	98S-965	98S-965
110A	Handle Nut Cap	110A-555	110A-555
134	Gear Stud	134-965	134-965
159	Shift Arm Spring	159-965	159-965
173	L.S. Bearing Retainer	173-965	173-965
176	Anti-Backlash Brakes (4 req.)	176-965	176-965
177	Brake Selection Knob	177-965	177-965
183	Frame Assembly	183-955	183N-965

KEY NO.	DESCRIPTION	MODEL 955 PART NO.	MODEL 965 PART NO.
1	Right Side Plate	1N-965	1N-965
3	Inner R.S. Plate	3-965	3-965
4	Fibre Washer	4-60	4-60
5	Main Gear	5-965	4-60
6	Drag Washer HT-100 (Set of 3)	6C-965	6C-965
7	Metal Drag Washer (Set of 3)	7C-965	7C-965
8	Star Tension Washer	8-965	8-965
10	Star Drag	10-965	10-965